



### FIŞ ÇEKİRDEK

Vidalı terminal

Kablo pabuçlu

Kablo: 0.5 - 1.5 mm<sup>2</sup>

### Male Insert

Screw terminal

With wire protection

Wire: 0.5 - 1.5 mm<sup>2</sup>

Parça No. / Part No.

**29009**

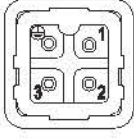

21

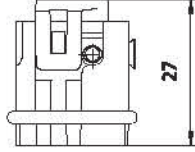
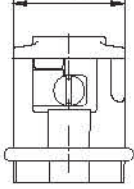

27

Amb. /Adet - Packing/Pcs. 100

4\*10A (3P+E)



### PRİZ ÇEKİRDEK

Vidalı terminal

Kablo pabuçlu

Kablo: 0.5 - 1.5 mm<sup>2</sup>

### Female Insert

Screw terminal

With wire protection

Wire: 0.5 - 1.5 mm<sup>2</sup>

Parça No. / Part No.

**29008**

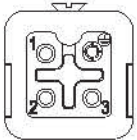

21

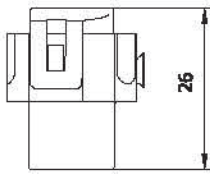
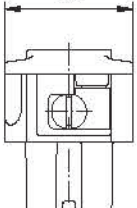

26

Amb. /Adet - Packing/Pcs. 100