

Accessories

Type ET (end sleeve)



-40 to +120 °C
Short periods +150 °C



Thermoplastic elastomer



HB



IP 67

The end sleeve can be used to close the open end of a conduit or to centre cables coming out of a conduit.

- Opening of end sleeve variable (depending on the cable diameter used)
- Easy assembly
- Fixing of end sleeve to the cable protection conduit using ribs running round the inside

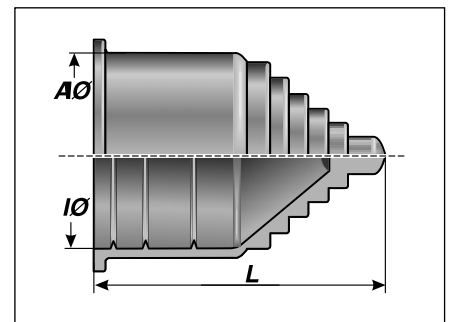

ET

Type	Order no.	Colour	Suitable for Murrflex	L mm	A Ø mm	I Ø mm	Cable Ø mm	Pack qty
ET 07	83723410	Grey	Pg6	29.0	13.0	10.0	1.0-8.0	50
ET 07	83723450	Black	Pg6	29.0	13.0	10.0	1.0-8.0	50
ET 09	83723412	Grey	M10 / P7; M12 / P9	32.5	16.0	13.0	1.0-10.0	50
ET 09	83723452	Black	M10 / P7 ; M12 / P9	32.5	16.0	13.0	1.0-10.0	50
ET 11	83723414	Grey	M16/P11	36.5	19.0	15.8	4.0-12.0	50
ET 11	83723454	Black	M16/P11	36.5	19.0	15.8	4.0-12.0	50
ET 16	83723416	Grey	M20 / P16(S)	37.5	25.0	21.2	6.0-16.5	50
ET 16	83723456	Black	M20 / P16(S)	37.5	25.0	21.2	6.0-16.5	50
ET 21	83723418	Grey	M25 / P21(S)	40.2	32.0	28.5	6.0-23.0	25
ET 21	83723458	Black	M25 / P21(S)	40.2	32.0	28.5	6.0-23.0	25
ET 29	83723420	Grey	M32 / P29(S)	44.2	39.0	34.5	6.0-29.0	25
ET 29	83723460	Black	M32 / P29(S)	44.2	39.0	34.5	6.0-29.0	25
ET 36	83723422	Grey	M40 / P36(S)	46.0	46.0	42.5	10.0-37.0	25
ET 36	83723462	Black	M40 / P36(S)	46.0	46.0	42.5	10.0-37.0	25
ET 48	83723424	Grey	M50 / P48(S)	52.0	59.0	54.5	10.0-47.0	10
ET 48	83723464	Black	M50 / P48(S)	52.0	59.0	54.5	10.0-47.0	10